

RECHARGE

URPA CONFERENCE 2015

March 8 – 11, 2015

Utah Valley Convention Center

220 West Center Street • Provo • Utah

Exhibitor Invite

Look Inside for:

Exhibitor Information

Exhibitor Hall Layout

Exhibitor Agreement/Registration Form



UTAH RECREATION & PARKS

ASSOCIATION

www.urpa.org

We invite YOU to Exhibit

This year will be **BIGGER** and **BETTER** than ever with more delegates expected to attend the Exhibit Hall in Provo.

Don't be left in the DARK!
Sign up today!

Schedule at a Glance

Sunday, March 8, 2015

Opening Social 5:00 pm - 8:00 pm

Monday, March 9, 2015

Opening
Keynote Speaker 8:00 am - 9:15 am
Educational Sessions 9:25 am - 12:10 pm
Funday Activities 12:10 pm - 2:00 pm
Educational Sessions & Roundtables 2:00 pm - 5:45 pm
Central Region BBQ 6:00 pm

Tuesday, March 10, 2015

Exhibit Hall
Set Up Time 7:30 am - 10:00 am
General Session 8:30 am - 9:45 am
Educational Sessions 10:00 am - 11:15 am
Exhibit Hall 10:00 am - 3:00 pm
(Non-Compete Time 11:15 am - 2:30 pm)
Educational Sessions 2:30 pm - 5:15 pm
Happy Hour 5:30 pm - 6:30 pm
Awards Banquet & Live Auction 6:30 pm

Wednesday, March 11, 2015

South Region
Golf Tournament 9:00 am - 1:00 pm

Your Booth Fee Includes*:

- 10' x 10' booth
- 3' Side Drape/8' Back Drape
- 8' Draped Table
- Two Chairs
- Waste Basket
- Wi-Fi
- ID Placard/Name Badge
- Exhibit Lunch for 2 People
- Attendee List

**Additional items available upon request, see attached Exhibitor Service Order Form.*

A limited number of PRIME booth spaces are available. Be the first to request, first come first serve OR be sure to get your requested booth by sponsoring an event. See attached Exhibit Hall map for available locations.

Enjoy the perks of Exhibiting!

- Network with professionals interested in your product.
- Contact potential customers with purchasing power.
- Promote new products and services.
- Attend any of the educational sessions being offered.
- Company listing on URPA's website. (www.urpa.org)

URPA will be doing several giveaways during the luncheon to maximize the number of delegate foot traffic. In addition to this, URPA is asking each vendor to donate a giveaway (minimum of a \$50) item, which will be given at the end of the luncheon. This will insure that the delegates will attend the Exhibit Hall in its entirety. The proceeds earned will be given to the student scholarship fund.

UTAH RECREATION & PARKS ASSOCIATION 2015 CONFERENCE

Level 1 - Exhibit Hall Level

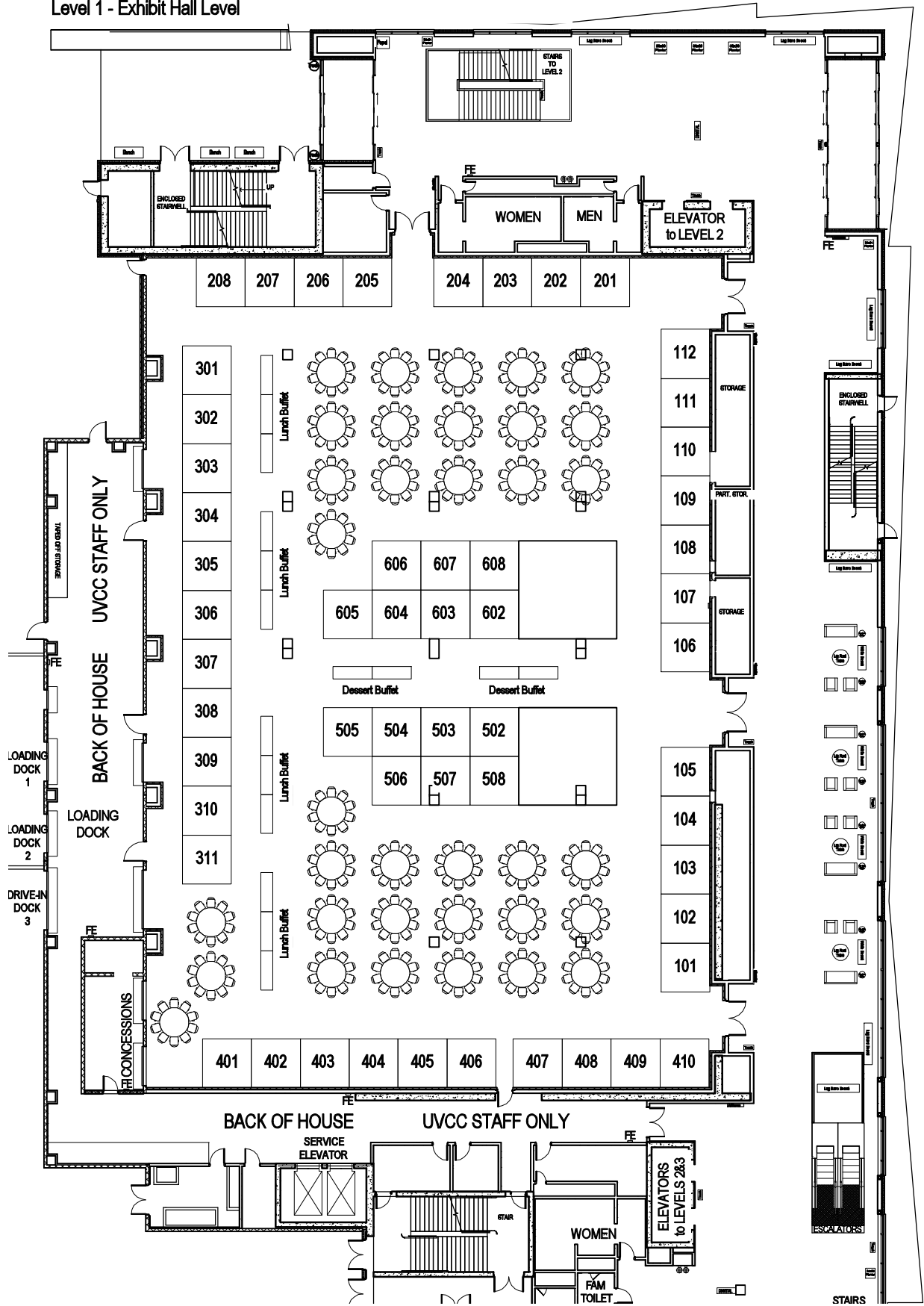

2015 URPA TRADESHOW EXHIBIT BOOTH CONTRACT



URPA

Booth assignments are made based on several factors. **If you have a preference for a booth location let us know and we will do our best to accommodate. Priority is given to our conference sponsors.** If you would like a premium location, please review our sponsorship opportunities and secure your preferred spot. URPA will have sole control over admission to the Exhibit Hall. No Delegate or Exhibitor will be admitted without proper identification, nor will they be allowed to enter the hall except during established Exhibit Hall hours. Unless otherwise noted, move-in hours are 7:30-10:00 am, the morning of March 10th prior to Exhibit Hall opening at approximately 10:00 am until 3:00 pm.

CANCELLATION POLICY - Should you find it necessary to cancel your booth space, the following cancellation policy will apply. A \$100 administrative fee will be assessed for any request for refund. The request must be received prior to February 23, 2015 to be eligible for refund. Requests received later than February 23, 2015 will not be eligible for refund unless the booth space can be re-sold and the entire Exhibit Hall sells out. No refunds will be available for any portion of the Exhibit Hall fees if it is cancelled due to weather or an occurrence of natural disasters. Exhibitors are encouraged to carry insurance that would cover them in the event the show is cancelled due to weather or a natural disaster.

COMPANY INFORMATION:

WE WOULD LIKE TO BE A CONFERENCE SPONSOR

YES

NO

MAIN CONTACT AND EMAIL ADDRESS

BOOTH LOCATION CHOICES: 1.____ 2.____ 3.____ 4.____ 5.____

COMPANY NAME

COMPANY MAILING ADDRESS

COMPANY MAILING ADDRESS

COMPANY CITY STATE ZIP

ONSITE EXHIBITOR INFORMATION:

1. ONSITE CONTACT FOR COMPANY (INCLUDED IN BOOTH RENTAL)

ONSITE CONTACT EMAIL

2. ONSITE CONTACT FOR COMPANY (INCLUDED IN BOOTH RENTAL)

ONSITE CONTACT EMAIL

3. ONSITE CONTACT FOR COMPANY

ONSITE CONTACT EMAIL

CONTACT MAILING ADDRESS (if different than above)

CONTACT CITY (if different than above)

STATE ZIP

COMPANY WEBSITE

CONTACT PHONE

CONTACT FAX

DESCRIPTION OF PRODUCTS OR SERVICES TO BE DISPLAYED (FOR PUBLISHING PURPOSES):

use additional paper, if necessary (50 words maximum)

SIGNATURE: *This acknowledges that you understand and agree to the terms as outlined in this contract. Booths will NOT be reserved without the company representative's signature.*

Date: _____

2015 BOOTH SPACE

URPA will assign the booths according to flow and need, in the above form you may give your desired booth locations or you can email Amy at amy@cemaquatics.com. Checks can be mailed to 2015 URPA Conference, Utah Recreation & Park Association, 3204 Mount Lomond Drive, North Ogden, Utah 84414.

First Name: _____ Last Name: _____
 Organization: _____ Title: _____
 Address: _____ City: _____ State: _____ Zip: _____
 Email: _____ Office/Home Phone: _____

Please check box if you will be attending any Educational Sessions.

Vendors who have purchased a booth receive two (2) tickets for the Exhibitor Luncheon. Additional meal tickets may be purchased at an additional cost (see meal prices below). You may elect to donate your meals to a student attendee.

A. Booth Rental

URPA Corporate Member **\$510*** Non-URPA Corp. Member **\$565***

**Early Bird Registration: receive 10% off booth price if registration and payment is received before 1/1/15*

NEW UPRA CORPORATE MEMBERSHIP INFORMATION: Your conference booth registration fee no longer includes your annual URPA membership. Annual memberships for your company can be purchased for \$100. In addition to your discounted booth for the conference, visit www.urpa.org for a list of benefits you'll receive with your corporate membership. For your convenience, you may pay your annual membership fee with your conference booth registration fee.

B. Extra Meal Tickets

Monday, March 9, 2015

BBQ \$20 x _____ per person
 steak chicken

Tuesday, March 10, 2015

Exhibit Hall Lunch (extra) \$20 x _____ per person
 Dinner (Banquet) \$45 x _____ per person
 steak salmon

C. Golf Tournament (Wednesday, March 11 am @ 9:00 am)

East Bay Golf Course, 1860 South East Bay Blvd., Provo, Utah

Individual \$50 Team \$50/player

Player Names:

1. _____
 2. _____
 3. _____
 4. _____

Vendor Booth (A) \$ _____ + extra meal tickets (B) \$ _____ + Golf Tournament (C) \$ _____ +
 Annual URPA Membership \$100 = \$ _____ TOTAL AMOUNT DUE \$ _____

2015 URPA Conference

Utah Recreation & Parks Association
 3204 Mount Lomond Drive, North Ogden, Utah 84414
 phone (801) 782-5512/fax (801) 782-5513/ kimo@urpa.org

Payment Information: Please Invoice me Check Enclosed Credit Card

Card #: _____ Expiration Date: _____ Sec Code: _____ Amount Paid: _____
 Cardholder Name: _____ Company: _____
 Address: _____
 City: _____ State: _____ Zip: _____ Phone: _____
 Cardholder Signature: _____ Email: _____